

Max. Flow Rate



Intelligent Peristaltic Pump

L100-1F, L100-1FS, L300-1F, L300-1FS, L600-1F, L600-1FS



7 inch color display, full touch screen and intuitive graphic interface, provide easy-to-use operations

Customize parameters by programming, and the parameter methods can be stored and easily recalled

Multiple function modules and intelligent algorithms are designed for a wide variety of applications, including routine and multi-step complex applications

• L100-1F, L300-1F, L600-1F

Pump can be controlled through touch screen, foot switch, analog signal and communication commands, combined with a variety of interfaces (USB, RJ11, DB9 etc.) for easy system connection

• L100-1FS, L300-1FS, L600-1FS

Automatic identification of pump head and tubing, simplify the operation process and provide reliable guarantee for high-precision fluid transferring

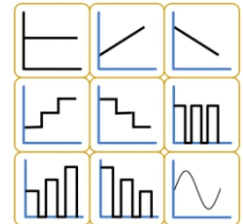

Running Control Module

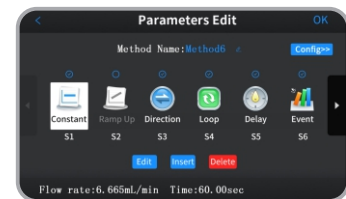

Parameter Program Configuration

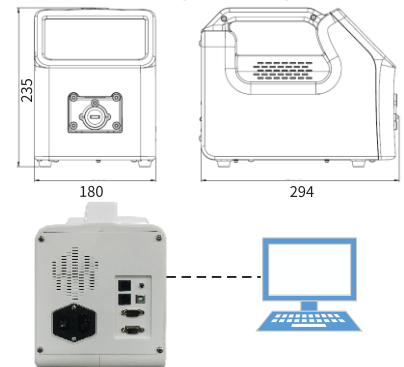

Upgrade the pump software through PC

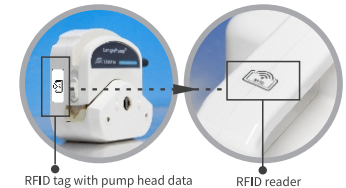

Automatic identification of pump head and tubing

| | L100-1F / L100-1FS | L300-1F / L300-1FS | L600-1F / L600-1FS |
|------------------------------------|---|--|-----------------------|
| Speed | ≤100rpm, CW/CCW | ≤300rpm, CW/CCW | ≤600rpm, CW/CCW |
| Speed resolution | 0.1rpm | 0.1rpm resolution when speed <100rpm, 1rpm resolution when speed ≥100rpm | |
| Flow rate | 0.15uL/min-500ml/min | 0.15uL/min-1500mL/min | 0.15uL/min-3000mL/min |
| Dispensing volume | 0.1mL-9999L(accuracy of ±2% with calibration) | | |
| Calibration | Improve the flow rate and dispensing volume accuracy. | | |
| Display | 7Inch 1024×600 color LCD | | |
| Language | Chinese or English, set as needed | | |
| Control mode | Touch screen control, footswitch control, external signal control and communication control | | |
| Work mode | Programming | | |
| Programming function | Running control module: constant, ramp up/down, stepped up/down, sine, constant dispensing, incremental/decremental dispensing. Logic control module: direction, delay, event trigger, status output, pause, jump, loop, stop. Configure multi-step program with multiple modules for complex application | | |
| External control | Start/stop control, direction control: logic level signal or switch signal(dry contact) Speed control: 0-5V, 0-10V, 4-20mA or 0-10kHz with uniform interface, max speed can be set. | | |
| Communication control | USB or RS485(RJ11) interface, Modbus protocol, multiple baud rate (1200/ 2400/ 4800/ 9600/ 19200/ 38400bps) | | |
| Status output | Output logic level signals to indicate pump running status, direction status, and other custom status. | | |
| Parameter method function | 7 parameter methods can be stored and easily recalled, 1 external control method is preset | | |
| Scheduled start | The delay start time can be set, and the pump will start running at desired time. | | |
| Back suction | Antidrip through setting back suction angle and delay time for high dispensing accuracy | | |
| Dispensing volume setting range | 0.001uL-9999L | | |
| Dispensing time and Interval time | 0.5s-9000s | | |
| Dispensing cycle | 1-999999(0 for unlimited) | | |
| Time in fluid transferring modules | 1s-9000s (0s for continuous transfer without time limit) | | |
| Delay time setting range | 0.5s-9000s | | |
| Prime | Fast filling and emptying at full speed | | |
| EMC | Comply with EN 61326-1:2013 | | |
| Dimension (L×W×H) | 294×180×235(mm) | | |
| Power Supply | L100-1F-A/L300-1F-A:AC220V±20%, 50Hz/60Hz L100-1F-B/L300-1F-B:AC110V±20%, 50Hz/60Hz | | AC100V-240V,50Hz/60Hz |
| Power Consumption | 35W | 55W | 100W |
| Condition | temperature:0°C-40°C relative humidity:<80% | | |
| IP rating | IP31 | | |
| Weight | 5.0kg | | |

| Pump Head | Tubing | Max Flow Rate Reference (mL/min) | | | Weight(kg) |
|------------------------|---|----------------------------------|---------------------|----------------------|------------|
| | | L100-1F/L100-1FS | L300-1F/L300-1FS | L600-1F/L600-1FS | |
| YZ1515x,YZ1115 | 13", 14", 19", 16", 25", 17", 18" | 380 | 1100 | 2200 | 5.4 |
| YZ2515x | 15", 24" | 266 | 800 | 1600 | 5.4 |
| YZ1125 | 15", 24", 35", 36" | 500 | 1500 | 3000 | 5.4 |
| FG15-13 | 13", 14", 19", 16", 25", 17", 18" | 430 | 1200 | 2400 | 5.3 |
| FG25-13 | 15", 24" | 270 | 1100 | 2200 | 5.3 |
| DMD15-13-B | 2×13",2×14",2×19",2×16",2×25" | 375 | 1035 | 2070 | 5.4 |
| BZ15-13-A | 14" | 22 | 75 | 150 | 5.3 |
| BZ15-13-B | 16" | 80 | 230 | 460 | 5.3 |
| BZ15-13-C | 25" | 150 | 480 | 960 | 5.3 |
| BZ15-13-D | 17" | 270 | 800 | 1600 | 5.3 |
| BZ25-13-B | 24" | 250 | 800 | 1600 | 5.3 |
| DG15-24 | 16", 25", 17" | 300(Single Channel) | 900(Single Channel) | 1800(Single Channel) | 5.8 |
| DG15-28 | 13", 14", ID≤3.17mm,Wall thickness:1mm | 75(Single Channel, speed≤100rpm) | | | 5.7 |
| DG-(1,2,4,6,8)6rollers | ID≤3.17mm, Wall thickness:0.8-1mm | 48(Single Channel, speed≤100rpm) | | | 5.2-5.6 |
| DG-(1,2,4)10rollers | ID≤3.17mm, Wall thickness:0.8-1mm | 32(Single Channel, speed≤100rpm) | | | 5.2-5.4 |